

Zygomatic ²

PLUS



S.I.N.
Implant System

Zygomatic



PLUS

- ***SMOOTH AND POLISHED SURFACE IN THE CERVICAL AREA:***

Coated with a smooth surface, facilitating easy cleaning, and reducing biofilm buildup.

- ***AGGRESSIVE AND COMPRESSIVE THREADS:***

Offers unique performance and enables faster implant locking.

- ***16° MORSE TAPER CONNECTION:***

Generates high mechanical strength.

- ***SHARP APEX TO FACILITATE IMPLANT INSERTION:***

Provides optimal results for severe cases of maxillary resorption.



IDEAL FOR IMMEDIATE LOADING



LIST OF APPLICABLE PRODUCTS

CODE	THREAD DIAMETER (MM)	PLATFORM DIAMETER (MM)	LENGTH (MM)
ILMZ 4030EN	Ø4.0	Ø4.0	30
ILMZ 4032EN	Ø4.0	Ø4.0	32.5
ILMZ 4035EN	Ø4.0	Ø4.0	35
ILMZ 4037EN	Ø4.0	Ø4.0	37.5
ILMZ 4040EN	Ø4.0	Ø4.0	40
ILMZ 4042EN	Ø4.0	Ø4.0	42.5
ILMZ 4045EN	Ø4.0	Ø4.0	45
ILMZ 4047EN	Ø4.0	Ø4.0	47.5
ILMZ 4050EN	Ø4.0	Ø4.0	50
ILMZ 4052EN	Ø4.0	Ø4.0	52.5
ILMZ 4055EN	Ø4.0	Ø4.0	55
ILMZ 4057EN	Ø4.0	Ø4.0	57.5
ILMZ 4060EN	Ø4.0	Ø4.0	60

Immediate results and shorter treatment time

The Zygomatic implant offers an immediate solution to patients as an alternative to bone graft procedures. It ensures stability, predictability, and treatment precision, meeting patient expectations through its versatile design and options tailored to anatomical features and tissue relationships.



PROSTHETIC COMPONENTS

Multi-unit conical abutment types with angulations of 17°, 30°, 45°, 45° Slim, 52°, and 60° with gingival heights ranging from 2.0 to 4.0 mm. Made of titanium alloy and anodized in gold color, with a locking torque of 20Ncm.

Protectors are screwed over the standard multi-unit abutments with manual torque (maximum 10ncm) and should remain in position until the provisional or definitive prosthesis is manufactured.



ZYGOMATIC SURGICAL KIT

Exclusive DLC (Diamond-Like Carbon) Coated Drills:

Reducing bone heating; increasing durability; high cutting power and a sharper angle.

Solutions without grafts for severe maxillary resorptions.

Depth probe to ensure the correct implant site depth.



Linear and intuitive sequence.



20 N.cm

ANGLED MULTI-UNIT ABUTMENT

CODE	ANG.	DIAM. (mm)	LENGTH (mm)
MAAM 4802I	17°	4.8	2
MAAM 4803I	17°	4.8	3
MAAM 4804I	17°	4.8	4
MAAM 4832I	30°	4.8	2
MAAM 4833I	30°	4.8	3
MAAM 4834I	30°	4.8	4
MAAM 4842I	45°	4.8	2
MAAM 4843I	45°	4.8	3
MAAM 4842	45° Slim	4.8	2
MAAM 4843	45° Slim	4.8	3
MAAM 48515I	52°	4.8	1.5
MAAM 48525I	52°	4.8	2.5
MAAM 48615I	60°	4.8	1.5
MAAM 48625I	60°	4.8	2.5



ABUTMENT PROTECTOR

CODE
PMA 4855
5,0 mm Profile



OPEN TRAY TRANSFER

CODE
TMAM 4800



ANALOG

CODE
ANMA 4800



CLOSE TRAY TRANSFER

CODE
TMFM 4800

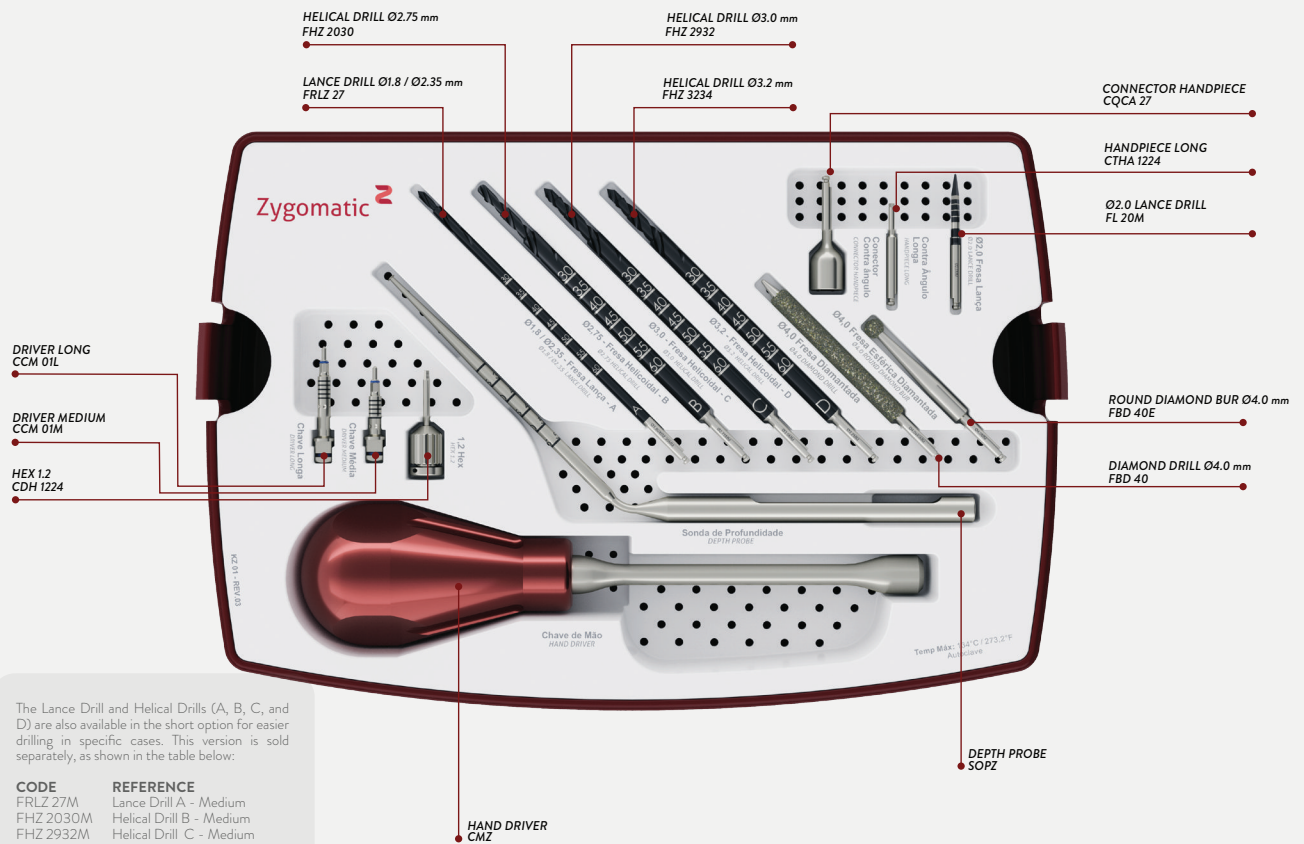

The Lance Drill and Helical Drills (A, B, C, and D) are also available in the short option for easier drilling in specific cases. This version is sold separately, as shown in the table below:

CODE	REFERENCE
FRLZ 27M	Lance Drill A - Medium
FHZ 2030M	Helical Drill B - Medium
FHZ 2932M	Helical Drill C - Medium
FHZ 3234M	Helical Drill D - Medium

HAND DRIVER CMZ

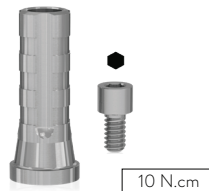

TEMPORARY TITANIUM CYLINDER

CODE

PTM 4800-3	For straight multi-unit
PTMS 4800-3	For straight multi-unit Suitable for laser welding
PTM 4800-2	For angled multi-unit



CALCINABLE AND CO-CR CYLINDER

CODE

CPM 4800-3	Plastic for straight multi-unit
CLEM 4800-3	Cobalt chrome for straight multi-unit
CPM 4800-2	Plastic for angled multi-unit
CLEM 4800-2	Cobalt chrome for angled multi-unit



POLISHING PROTECTOR

CODE

PPM 01



LABORATORY SCREW

CODE

CODE	DIAM. (mm)
PL 1405 Short	1.4
PTMA 13-1 Long	1.4



RETAINING SCREW

CODE

CODE	LENGTH (mm)	
PRH 20	2	For angled multi-unit
PRH 30	3	For straight multi-unit

S.I.N. 360

Discover the S.I.N. 360 Advanced Digital Workflow



7755 E Gray Rd
Scottsdale, AZ 85260

(866) 507-9315

www.sin360.us

Visit our social channels:

Instagram
[@sidentalusa](https://www.instagram.com/sidentalusa)

Facebook
[@sidentalusa](https://www.facebook.com/sidentalusa)

YouTube
[@sidentalusa](https://www.youtube.com/sidentalusa)